

WIND MILL APPLICATION

SEALING SOLUTIONS FOR
WIND TURBINE & GEARBOXES

Rotor Hub, Main Shaft

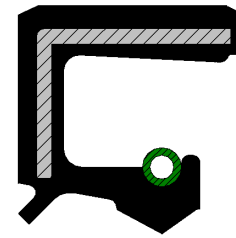
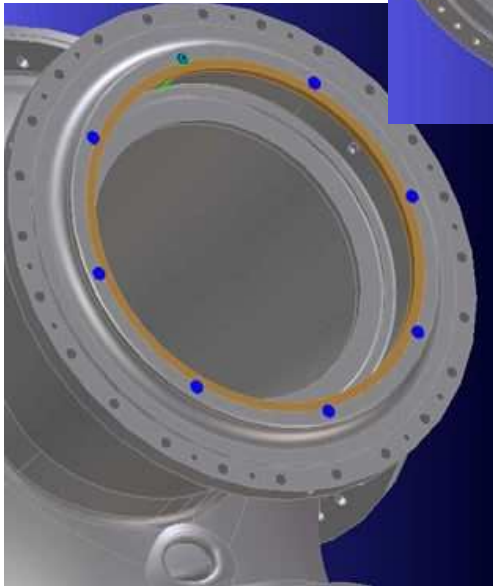
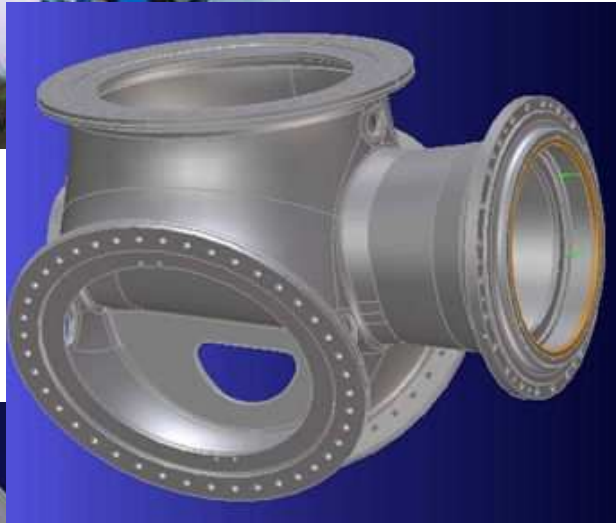

GP

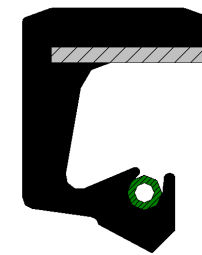

TGF

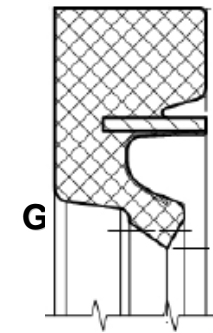

GMF - SPLIT

Pitch and Yaw Bearing

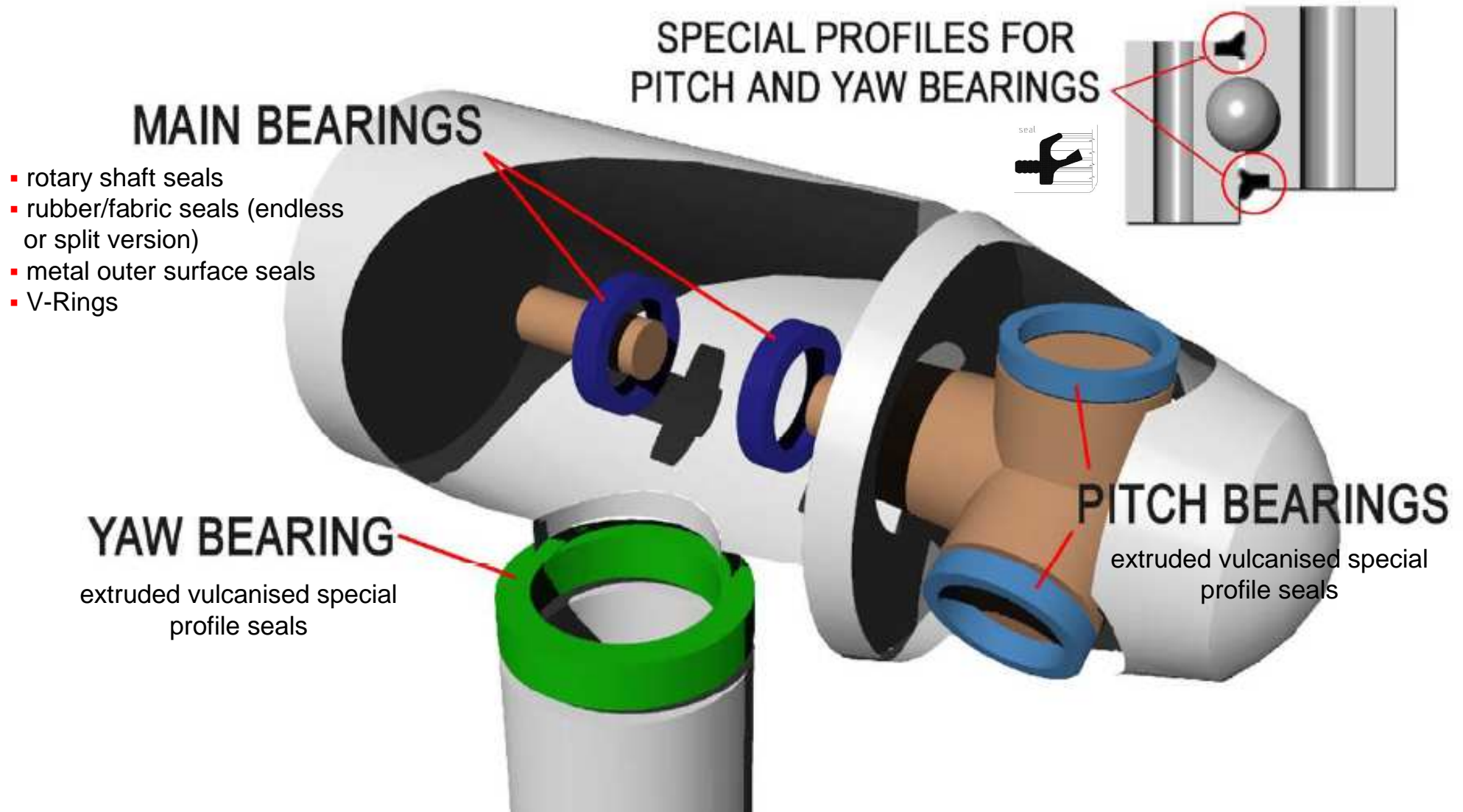

FP-ATS Sealing Solutions in Wind Turbine

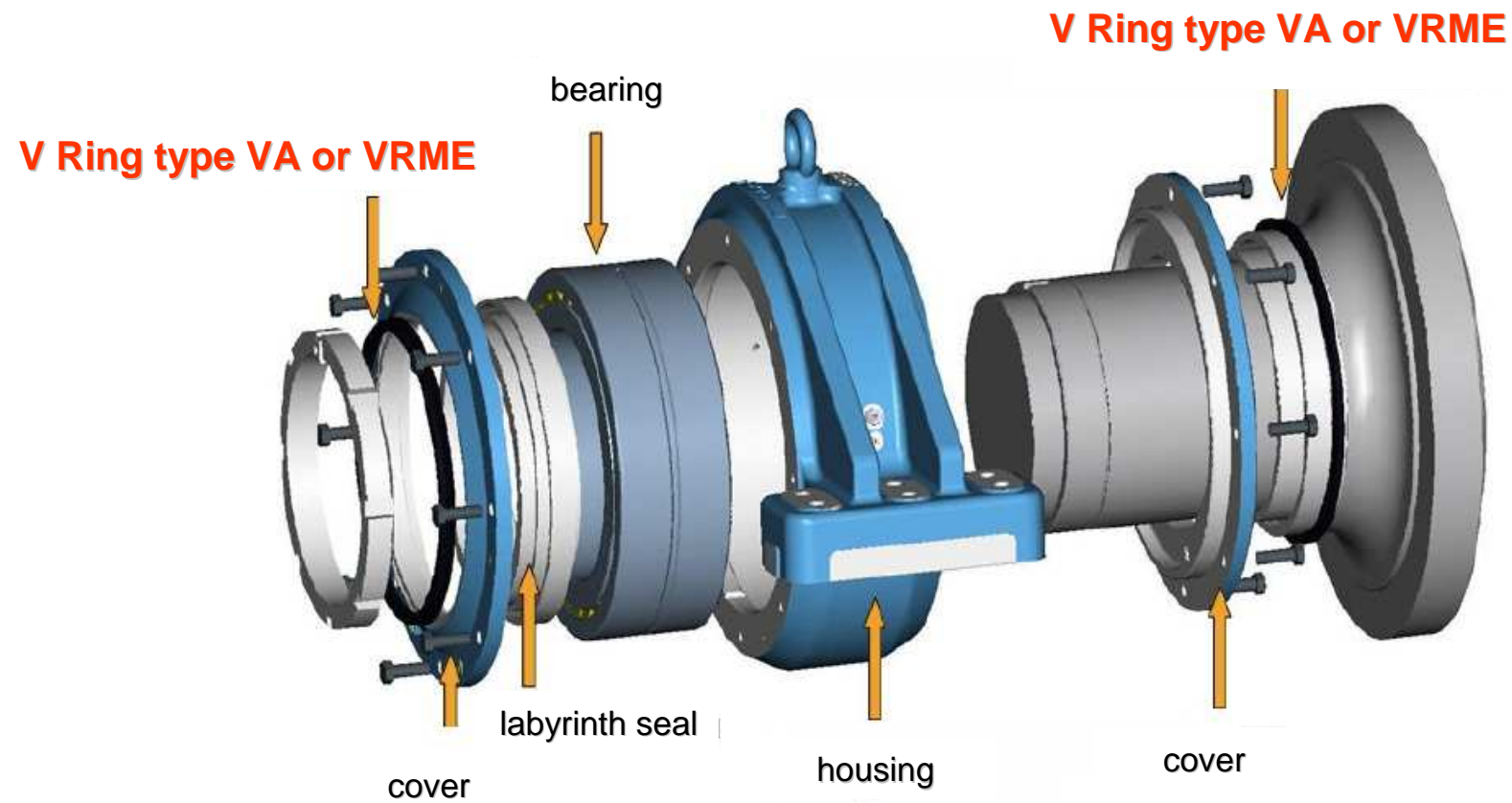

Gearbox

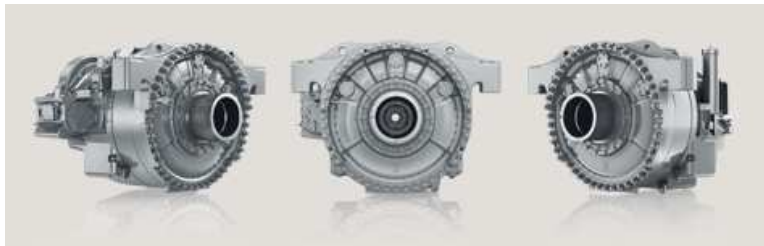
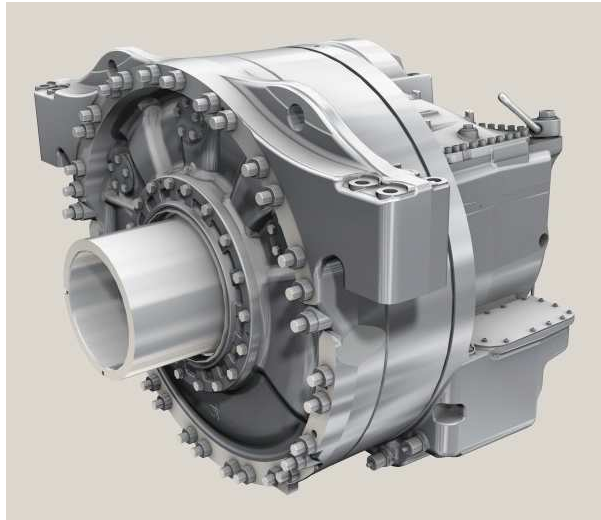

APPLICATIONS

- Helical – Mill Gearbox
- Planetary Gearbox

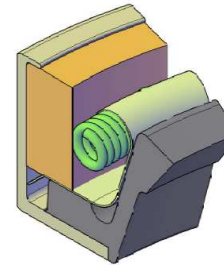

- FP-ATS “L2M” oil seal is suitable for high misalignments and vibrations
- FP-ATS “L2M – VF” seal is suitable for high temperature and running with poor lubrication

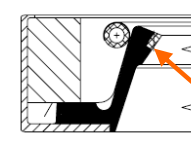

PTFE

vulcanized in the
sealing lip

Seals for wind turbines

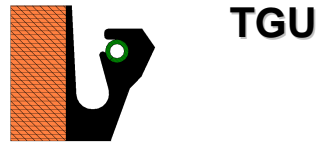

TGU



TGUP

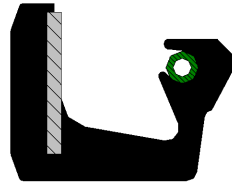

TGF

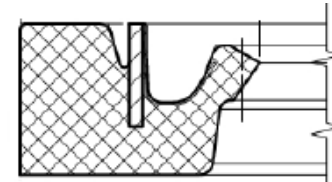

GMF

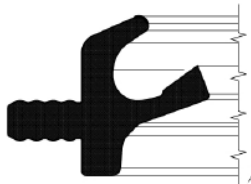

**special YAW
BEARING SEAL**

- Textile seal
- Metal OD and all rubber metal reinforced seal
- Special seals for yaw and pitch bearing
- V Rings
- Split seals
- O Rings

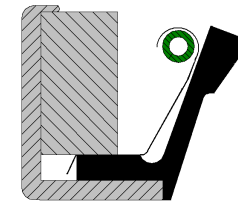

L2M

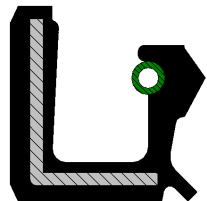

GP



V RING



O RINGS



30 YEARS OF EXPERIENCE

success, innovations
and
worldwide satisfied customers